

Treuil de halage à cliquet / Ratchet towing winch

Treuil pour application de halage, 1,2 ou 3 vitesses selon modèles et interdit au levage.
 Cliquet réversible 3 positions (montée, descente, neutre)
 Frein de retenue pour charge lourde selon modèles
 Manivelle amovible
 Disponible en version pour sangle de 50 mm

Description

*Winch for towing use, 1,2 or 3 speeds depending on type, and forbidden to lift
 3 positions reversible ratchet (upward, downward, neutral)
 Holding brake for heavy loads depending on the type
 Removable handle
 Winch available for 50 mm webbing*

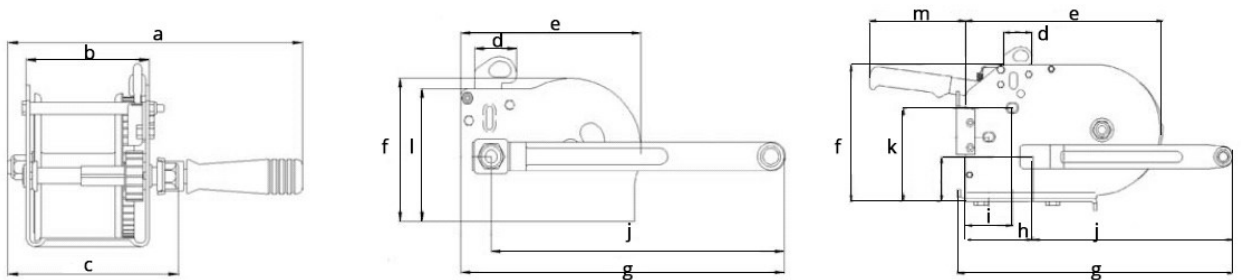

* Modèle équipé de frein ralentisseur / Type equipped with a retarder brake

| RÉF. / CODE | CMU WLL (kg) | Rapports Gears | | | Ø Axe Axis Ø (mm) | Dimensions Dimensions (mm) | | | | | | | | | | | | | Ø Câble Rope Ø (mm) | Max. Max. (m) | Poids Weight (kg) |
|----------------|--------------------|-------------------|--------|--------|-------------------------|----------------------------------|-----|-----|----|-----|-----|-----|----|----|-----|----|-----|-----|---------------------------|---------------------|-------------------------|
| | | Vitesse / Speed | | | | a | b | c | d | e | f | g | h | i | j | k | l | m | | | |
| | | 1 | 2 | 3 | | | | | | | | | | | | | | | | | |
| 200 667 | 470 | 1/2.57 | - | - | 25 | 230 | 90 | 130 | 38 | 125 | 100 | 200 | 27 | - | 174 | 30 | 88 | - | 3 | 22 | 2.0 |
| 200 668 | 596 | 1/3.5 | - | - | 22 | 240 | 99 | 140 | 38 | 161 | 127 | 240 | 27 | - | 213 | 57 | 118 | - | 5 | 17 | 3.0 |
| 200 669 | 656 | 1/3.5 | - | - | 22 | 240 | 99 | 140 | 38 | 161 | 127 | 240 | 27 | - | 213 | 57 | 118 | - | 5 | 17 | 3.2 |
| 200 670 | 723 | 1/4.85 | - | - | 28 | 242 | 100 | 142 | 38 | 200 | 166 | 240 | 27 | - | 213 | 81 | 140 | - | 5 | 32 | 4.6 |
| 200 671 | 894 | 1/4.85 | - | - | 28 | 270 | 120 | 165 | 38 | 214 | 171 | 253 | 40 | - | 213 | 83 | 141 | - | 6 | 21 | 6.0 |
| 200 672 | 894* | 1/4.85 | - | - | 28 | 285 | 120 | 165 | 38 | 214 | 171 | 300 | 40 | - | 260 | 83 | 141 | 150 | 6 | 21 | 6.0 |
| 200 666 | 1556* | 1/1.85 | 1/9.71 | - | 28 | 290 | 120 | 175 | 38 | 214 | 171 | 312 | 52 | 30 | 260 | 83 | 141 | 160 | 7 | 14 | 7.8 |
| 304 529 | 2741* | 1/1.25 | 1/10.9 | 1/21.8 | 50 | 345 | 163 | 230 | 38 | 265 | 190 | 348 | 88 | 66 | 260 | 55 | 175 | 130 | 8 | 14 | 13.1 |